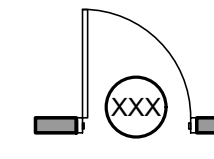
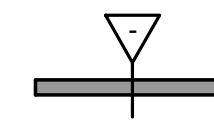
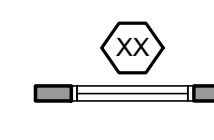
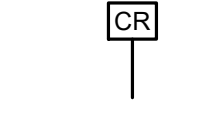
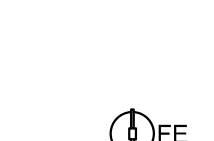
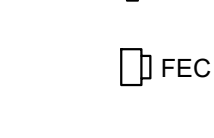
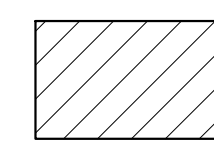

PARTITION PLAN LEGEND:

-  NEW OR RELOCATED DOOR & FRAME. SEE PARTITION PLAN TO COORDINATE LOCATIONS. SEE DOOR/FRAME/HARDWARE SCHEDULE FOR ADDITIONAL INFORMATION.
-  NEW G.W.B. & METAL STUD INTERIOR PARTITION CONSTRUCTION. SEE PARTITION TYPES ON DRAWING A0.30 FOR ADDITIONAL INFORMATION.
-  NEW INTERIOR WINDOW. SEE DRAWING AX.XX FOR ADDITIONAL INFORMATION.
-  CARD READER. PROVIDED BY TENANT. WIRING AND ALL RELATED ACCESSORIES. PROVIDE FIRE-RATED BLOCKING OR METAL STRAPPING. COORDINATE WITH TENANT AND/OR LANDLORD SECURITY, I.T. OR AV VENDOR(S). FIELD VERIFY LOCATIONS. SEE ENGINEERING DRAWINGS FOR ADDITIONAL INFORMATION.
-  FIRE EXTINGUISHER
-  FIRE EXTINGUISHER CABINET
-  HATCH INDICATES WORK N.I.C.

PARTITION PLAN GENERAL NOTES:

1. WHERE CASEWORK IS SHOWN ON EXISTING PARTITIONS, REMOVE GWB IN INSTALL BLOCKING. REPAIR, REFINISH WALL WITH WALL FINISH SCHEDULED

PARTITION PLAN KEYNOTES:

- P01** PROVIDE FLOOR TRANSITION STRIP. REFER DETAIL 2/A2.01
- P02** EXISTING CEILING, LIGHTING, MECHANICAL GRILLS, AND TO REMAIN
- P03** REMOVE EXISTING FLOOR COATING AND WALL BASE, PREPARE SUB FLOOR TO RECEIVE NEW SHEET VINYL FLOORING. HEAT WELD SEAM, PROVIDE FLASH COVE BASE DETAIL 3/A2.01. SPECIFICATION AS FOLLOWS:
MFR: ALTRO
STYLE: SYMPHONIA OR WALKWAY 20
COLOR: TO BE SELECTED FROM MFR. STANDARD RANGE
- P04** NOT USED
- P05** NOT USED
- P06** REMOVE OPERABLE PARTITION PANELS. PARTITION TRACK AND OVERHEAD STRUCTURE TO REMAIN. PARTITION POCKET TO REMAIN.
- P07** PAINT ALL WALLS WITHIN IN ROOM TO UNDERSIDE OF EXISTING CEILING. PAINT AS FOLLOWS:
GYP BOARD: PREVIOUSLY PAINTED
PRIMER: SW EXTREME BOND PRIMER, B51-150 SERIES
1ST COAT: SW PRO INDUSTRIAL WATERBASED CATALYZED EPOXY EG-SHEL, B73-360 SERIES
2ND COAT: SW PRO INDUSTRIAL WATERBASED CATALYZED EPOXY EG-SHEL, B73-360 SERIES
CMU: PREVIOUSLY PAINTED
PRIMER: SW EXTREME BOND PRIMER, B51-150 SERIES
1ST COAT: SW PRO INDUSTRIAL WATERBASED CATALYZED EPOXY EG-SHEL, B73-360 SERIES
2ND COAT: SW PRO INDUSTRIAL WATERBASED CATALYZED EPOXY EG-SHEL, B73-360 SERIES
- P08** REMOVE RUST FROM DOOR AND FRAME. REMOVE AND SALVAGE DOOR HARDWARE FOR RE-INSTALLATION IN SAME LOCATION. PRIME/PAINT DOOR AND FRAME. WHERE HOLLOW METAL SIDELITE OCCURS, PRIME/PAINT SIDELIGHT FRAME. CLEAN, CALIBRATE AND RE-INSTALL DOOR HARDWARE. COLOR TO MATCH EXISTING. PAINT SPECIFICATION AS FOLLOWS:
PRIMER: SW PRO INDUSTRIAL PRO-CRYL UNIVERSAL PRIMER
FIRST COAT: SW PRO INDUSTRIAL ACRYLIC SEMI-GLOSS
SECOND COAT: SW PRO INDUSTRIAL ACRYLIC SEMI-GLOSS

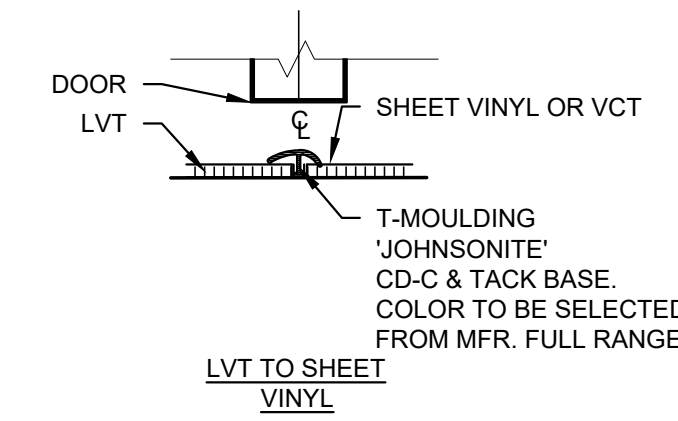

2 SECTION DETAILS - FLOOR TRANSITIONS
2.01 SCALE: 1/2" = 1'-0"

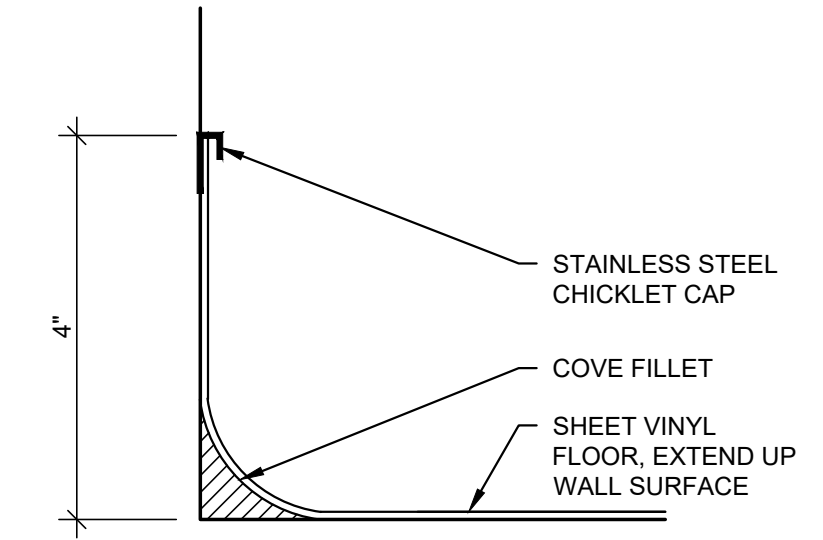

3 SECTION DETAIL - COVE BASE
A2.01 SCALE: 6" = 1'-0"

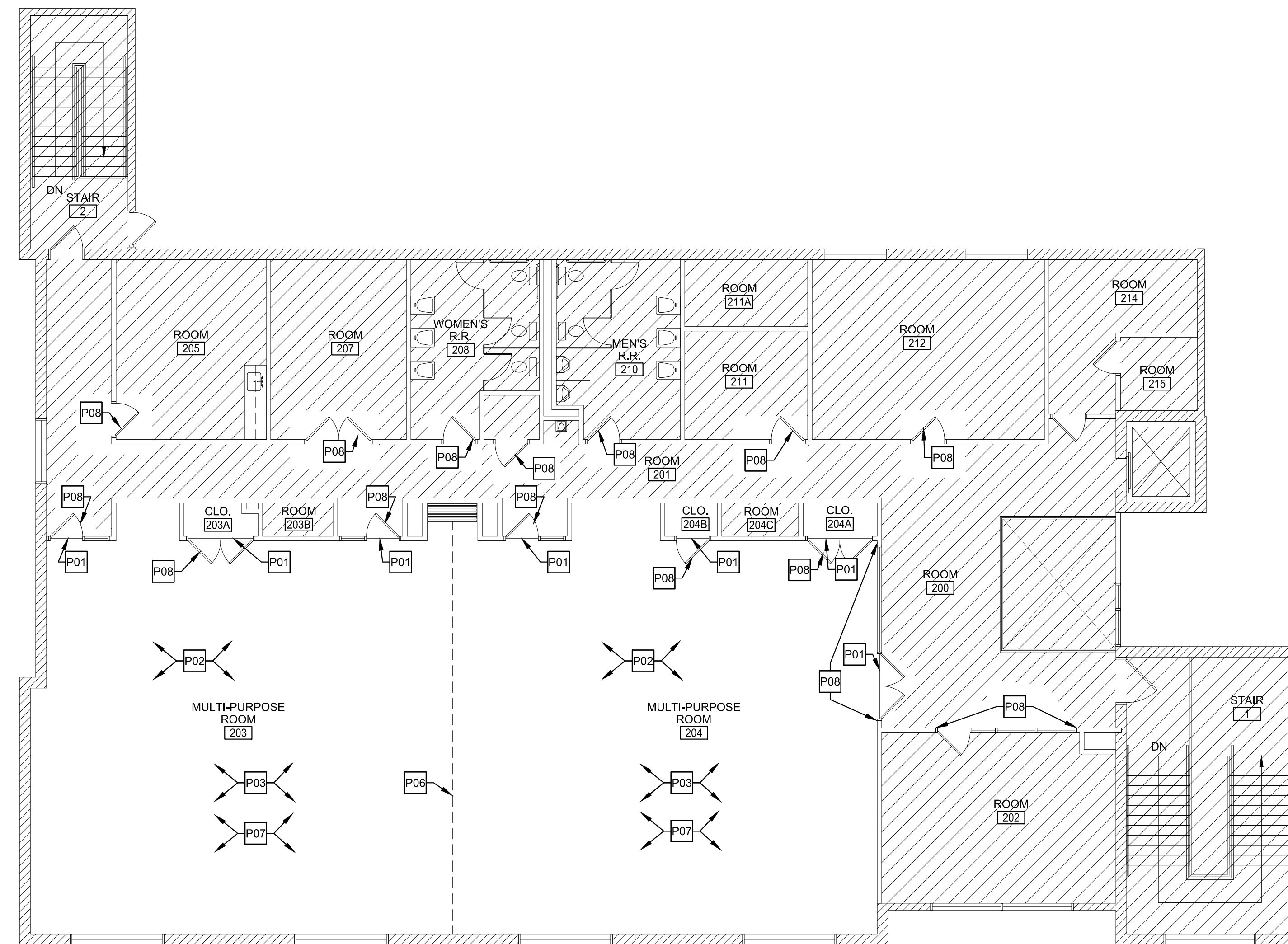

1 PARTITION PLAN - SECOND FLOOR
A2.01 SCALE: 1/8" = 1'-0"



THIS IS AN INSTRUMENT OF SERVICE NOT TO BE ALTERED, COPIED, OR USED FOR CONSTRUCTION WITHOUT WRITTEN PERMISSION FROM NEXT ARCHITECTURE, L.P. - COPYRIGHT 2022 (ALL RIGHTS RESERVED)

VERSIONS/REVISIONS:
07.15.22 95% CD Set
09.07.22 100% Review Set
02.10.23 Pricing Plan

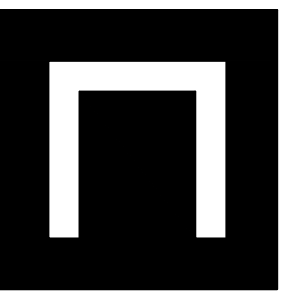

NEXT
architecture

1133 PENN AVENUE
SUITE 100
PITTSBURGH, PA 15222

P 412.681.1145
F 412.681.1165

www.next-architecture.net

HUMANE ANIMAL RESCUE PITTSBURGH
1101 WESTERN AVENUE
PITTSBURGH, PA 15233
ALLEGHENY COUNTY

PARTITION
PLAN -
SECOND FLOOR

DRAWING NO.

A2.01

PROJECT No. 22023.01